

AR Consultants, Inc.

Where Might You Find Important Archaeology in the DFW Area??

North Texas Association of
Environmental Professionals
May 20, 2026

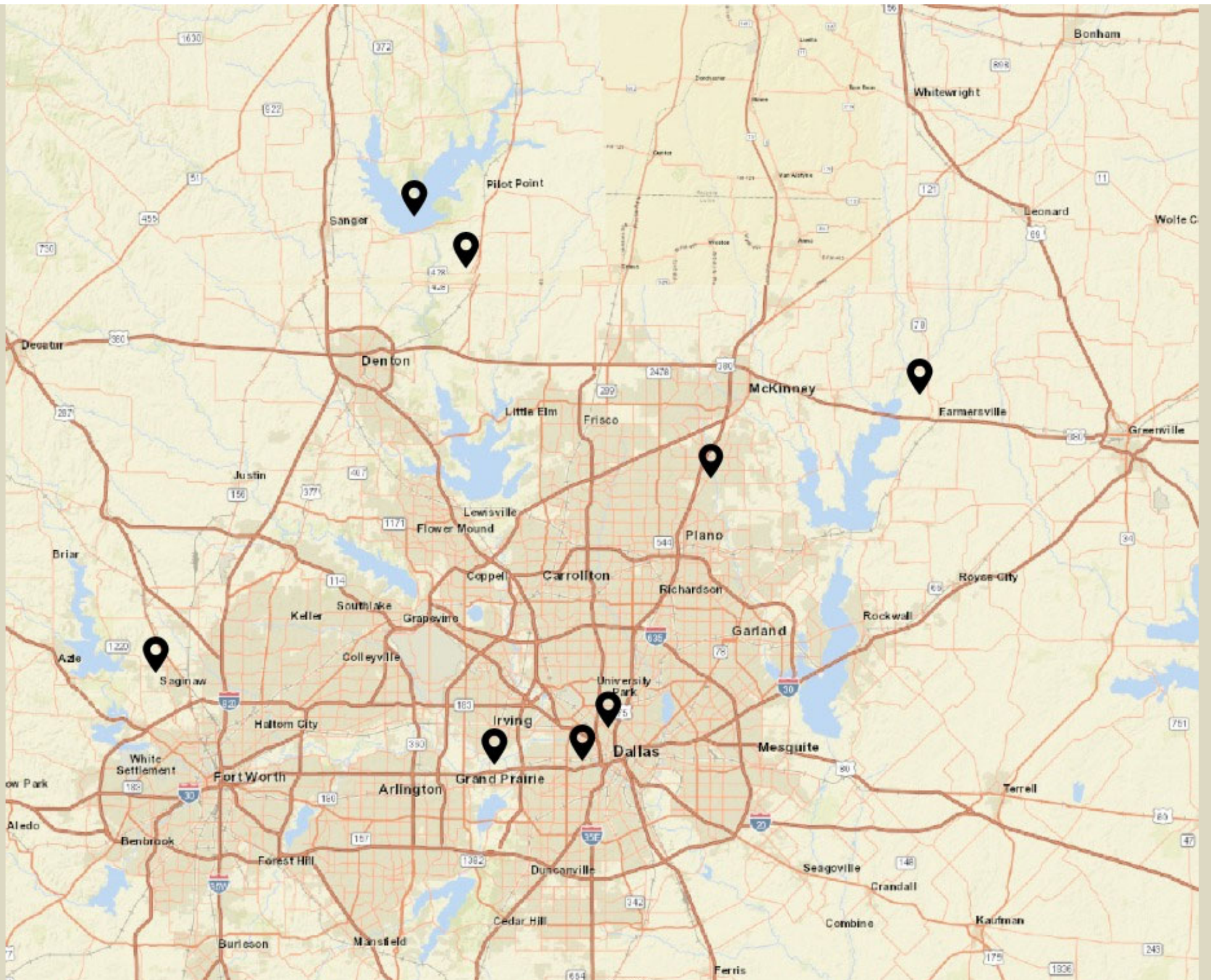

Why Do It? Legislation

- 404 or other permits from the Corps of Engineers
- Texas Antiquities Code applies to state, county, local agencies
- Chapter 711 of the Texas Health & Safety Code cemetery/grave/skeleton protection
- Due Diligence evaluations to assess potential





PH6-BHT-01

PH8-BHT-02

PH4-BHT-01

PH-05

PH-04

PH-01 Profile

West Fork

Pilot Point/
Point Bar

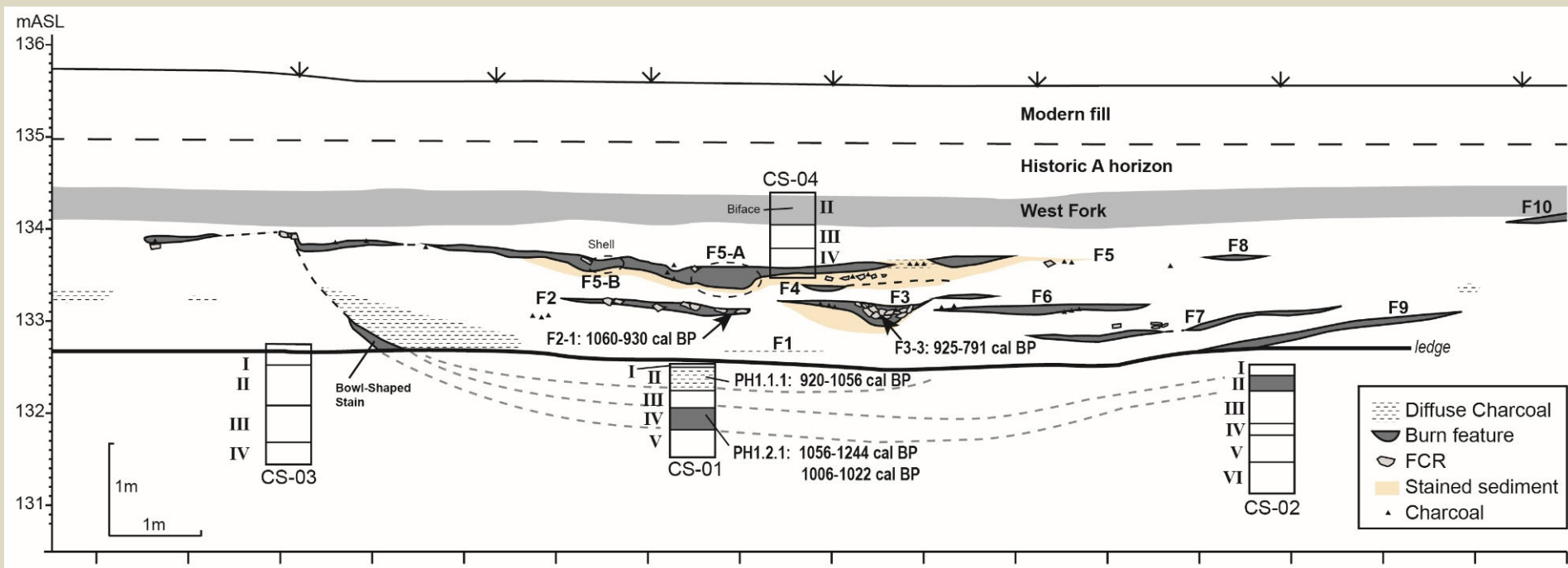



Aubrey Clovis Site during
overburden removal



Aubrey Clovis Site living floor



Clovis point
9,000-9,500 BC



Distinctive Artifacts from the Aubrey Clovis Site

1860 One Room Cabin



HABS

LOG HOUSE

IN THE FIRST DECADES OF THE TWENTIETH CENTURY, THIS FARMSTEAD WAS PART OF THE BLACK SHARECROPPING COMMUNITY CALLED "CROSSGROVE'S BOTTOM" AFTER A. P. CROSSGROVE, LAND OWNER AND PROMINENT PILOT POINT BUSINESSMAN. BETWEEN ABOUT 1920 AND 1930, THE HAL MITCHELL FAMILY RESIDED IN THIS HOUSE. MITCHELL'S FARM WAS SIMILAR TO OTHERS IN THE AREA, WITH A CASH CROP OF COTTON, SUPPLEMENTED BY CORN, GARDEN CROPS AND LIVESTOCK THAT WERE GROWN FOR FAMILY USE.

THE LOG ROOM OF THIS BUILDING WAS BUILT CA. 1860-1875, PROBABLY BY SOME OF THE EARLIEST SETTLERS IN THIS AREA. THE ONE-ROOM PLANK FRAME ADDITION WAS BUILT CA. 1925-1940. THE ADDITION WAS RECENTLY DEMOLISHED.

THE FOUNDATION OF THE LOG ROOM IS DRY-LAID SANDSTONE. THE SILLS ARE OF HENN OAK, AS ARE THE PLANK-SHAPED WALL LOGS. THE LOGS ARE CHINKED WITH SCRAPS OF LUMBER AND MORTAR, AND THE INTERIOR WAS WHITEMASHED AT ONE TIME. THE DEMOLISHED ADDITION WAS PLANK-FRAMED BOARD AND BATTEN. THE BUILDING WAS LAST ROOFED IN CORRUGATED TIN.

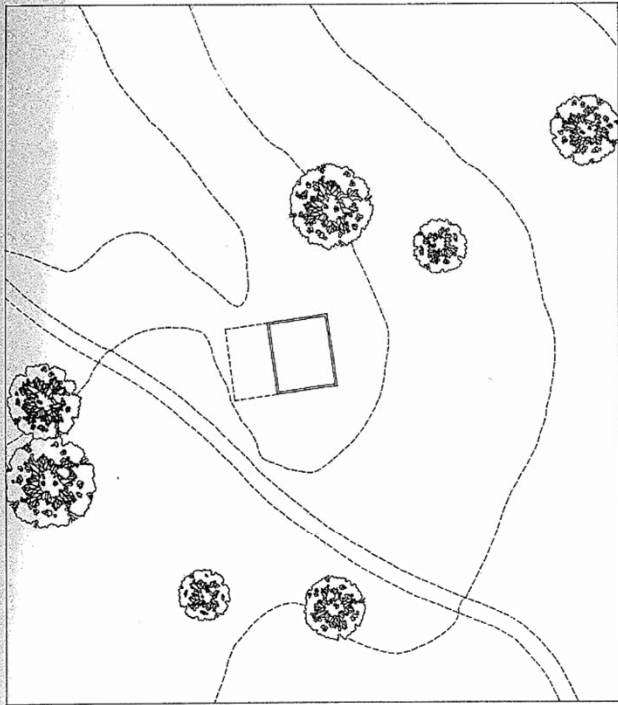

SITE PLAN

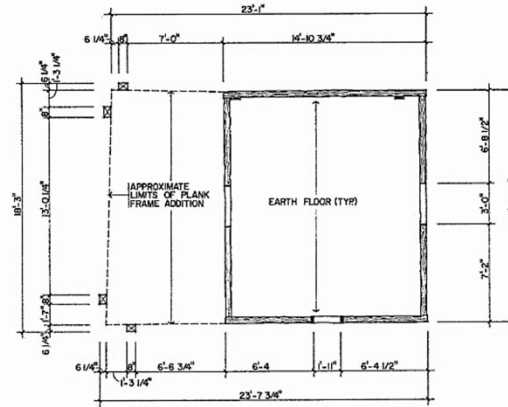
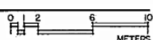

PLAN

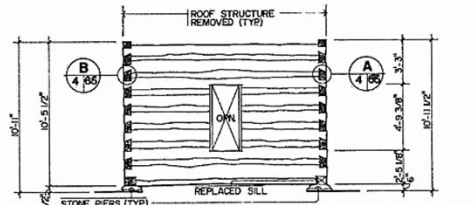

SOUTH ELEVATION

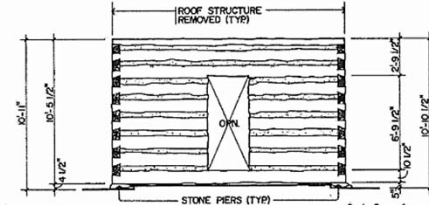
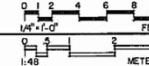

WEST ELEVATION

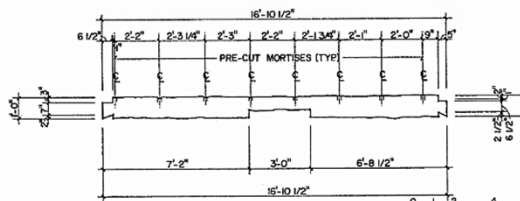
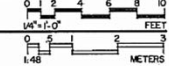

LOG DETAIL

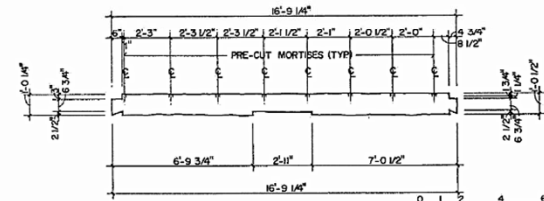
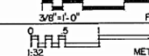

LOG DETAIL

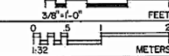

ALLEN STATION PARK

EST. 1998
CITY OF ALLEN























Joseph Redwine House

Joseph and Fannie "Puss" (Wilcoxson) Redwine, Zack Redwine's grand parents, built this house, probably in the early 1860's. It still stands on the east side of Hwy 78, about 2 miles north of town.

Joseph taught school at the Rose Hill School which was across the highway on the north side of CR 613. After Joseph's death Fannie married A. B. Robertson in 1883.







8/15/2012 8:54





8/15/2012 8:50



02/06/2013 09:26

DALLAS, TEXAS

1890

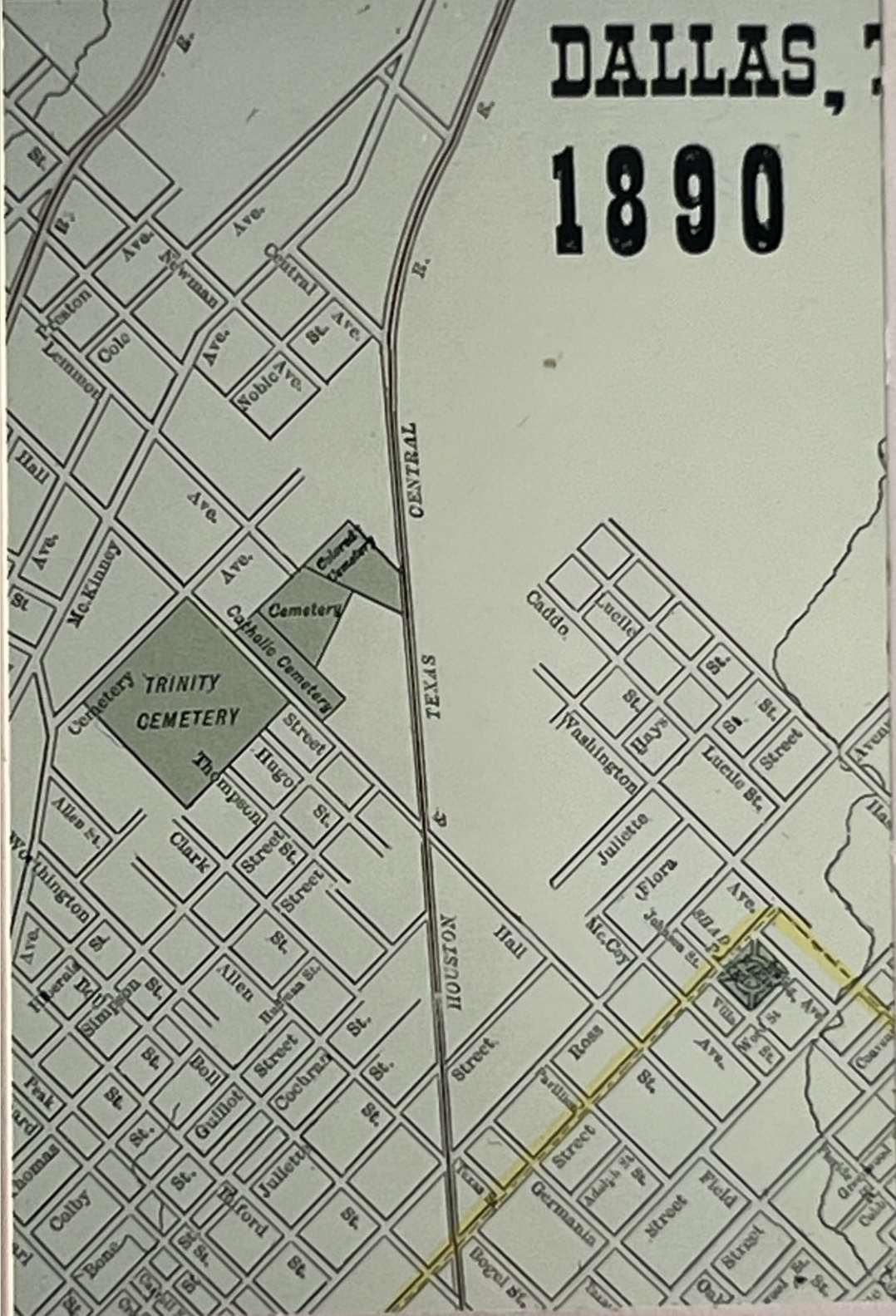





GRAPHIC SCALE

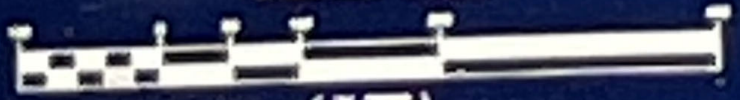

(IN FEET)
1 inch = 100 ft.





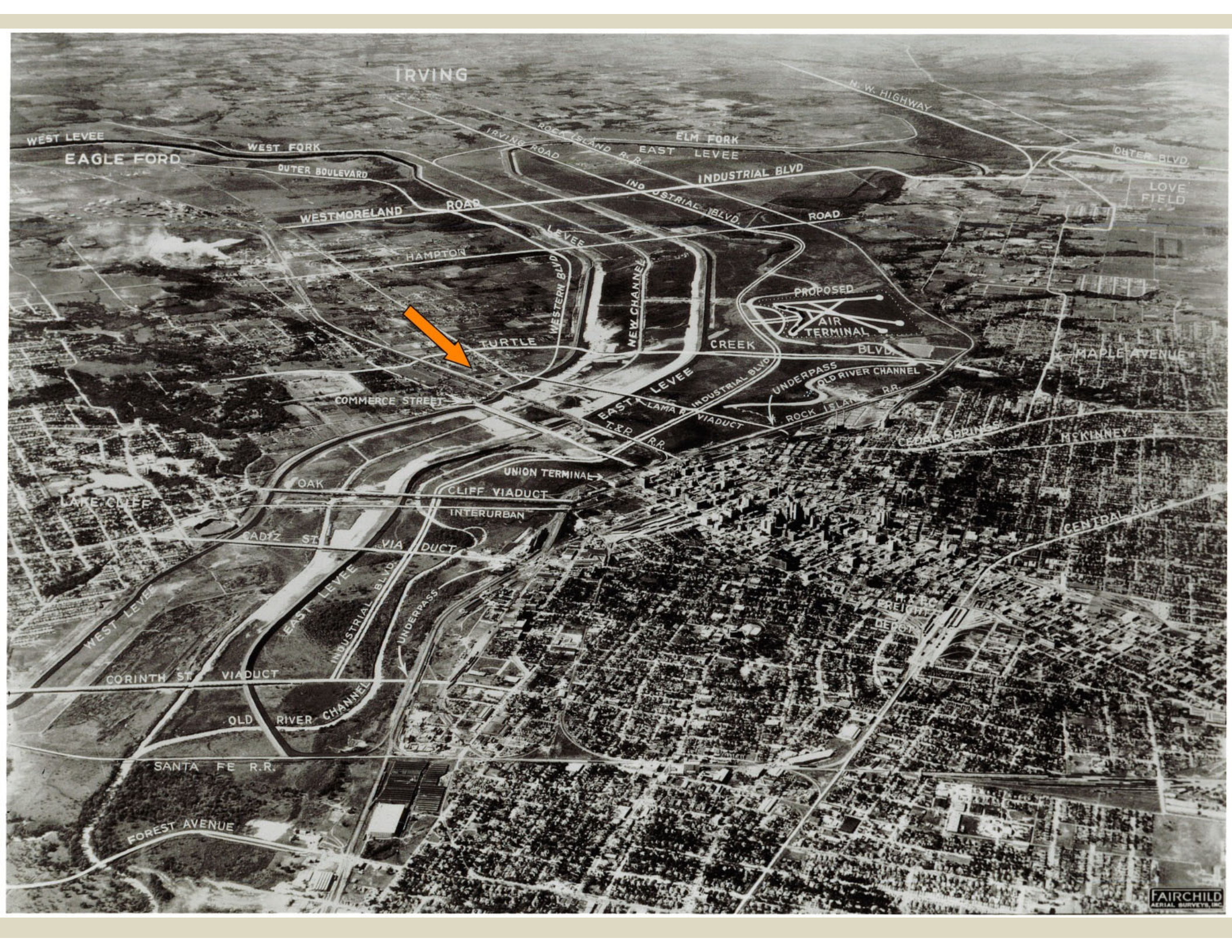

IRVING

N.W. HIGHWAY

WEST LEVEE
EAGLE FORD

WEST FORK
OUTER BOULEVARD

IRVING ROAD

ROEA ISLAND R.R.

EAST LEVEE

INDUSTRIAL BLVD

WESTMORELAND ROAD

HAMPTON

LEVEE

WESTERN BLVD

NEW CHANNEL

CREEK

PROPOSED
AIR TERMINAL

COMMERCE STREET

TURTLE

LEVEE

INDUSTRIAL BLVD

UNDERPASS

OLD RIVER CHANNEL

ROCK ISLAND R.R.

LAMA R.R.

VIADUCT

EAST T&R R.R.

UNION TERMINAL

CLIFF VIADUCT

INTERURBAN

LAKE CREEK

OAK

VIA DUCT

INDUSTRIAL BLVD.

UNDERPASS

WEST LEVEL

EAST LEVEE

CORINTH ST. VIADUCT

OLD RIVER CHANNEL

SANTA FE R.R.

FOREST AVENUE

CEDAR SPRINGS

MCKINNEY

CENTRAL AVE.



TRINITY GROVES

Cleared Cemetery Site



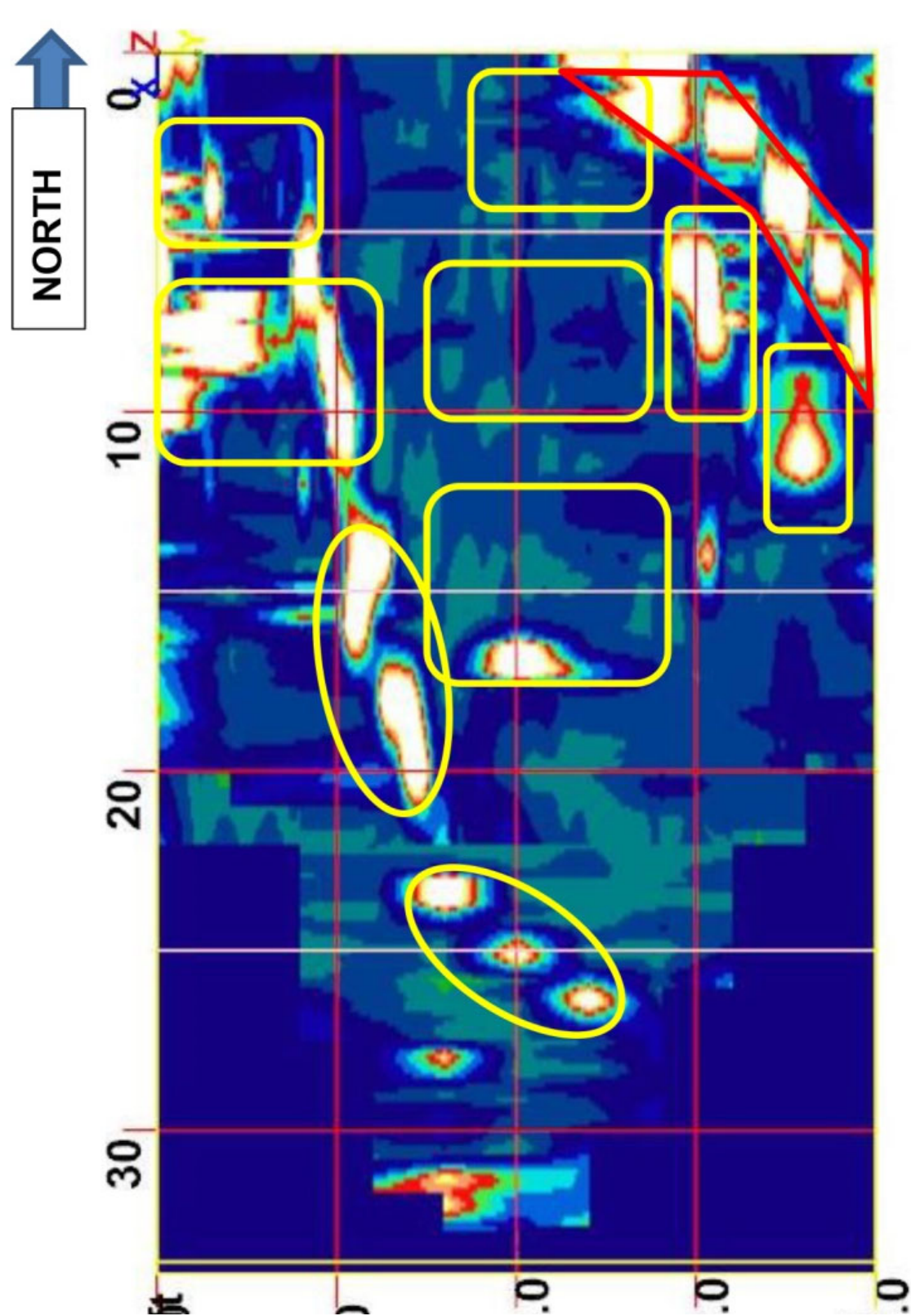

Ground
Penetrating
Radar (GPR)
Anomalies,
thanks to
Terracon

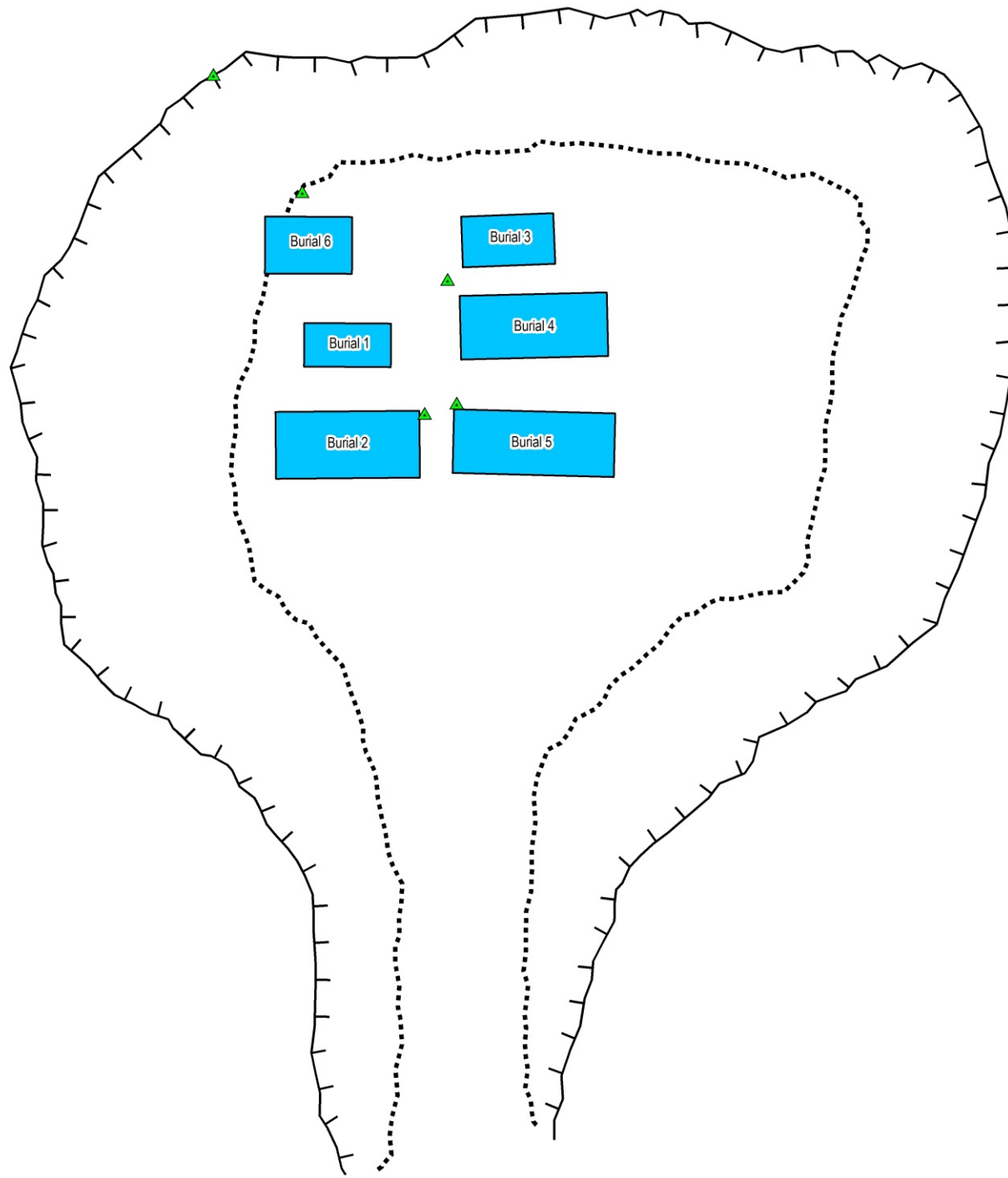

Scott Cemetery Relocation

▲ Datum Pit Floor Edge



Coordinate System: NAD 1983 UTM Zone 14N

Data Source: Cemetery boundary derived from historic plat maps; pit rim edge, pit floor edge, and grave shafts were mapped



ARC No: 151104
Drawn By: NAC
Date: 10/4/2016



Burial 5

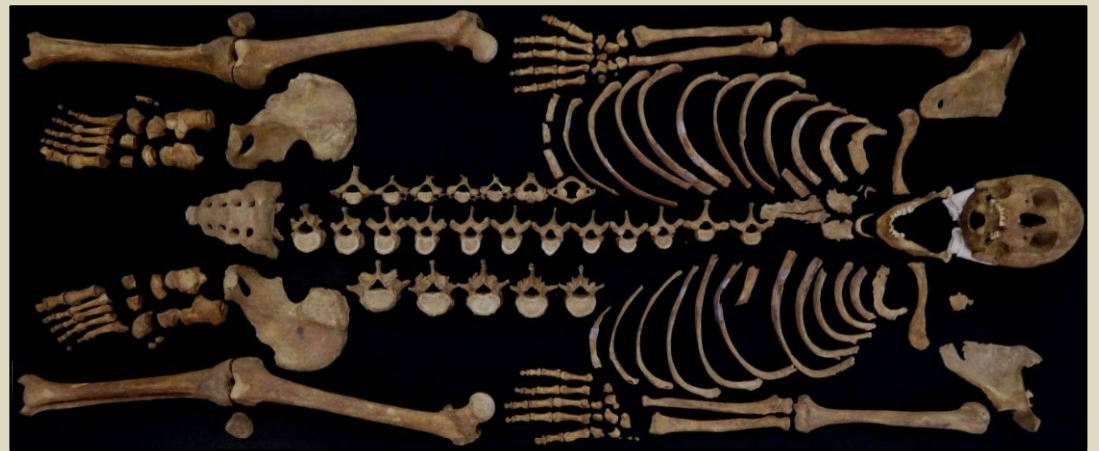
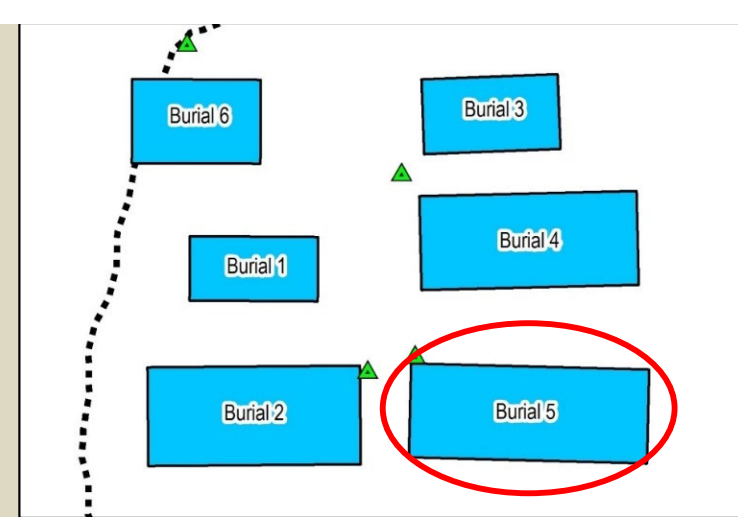

Oak Grove Memorial Gardens Cemetery - Irving



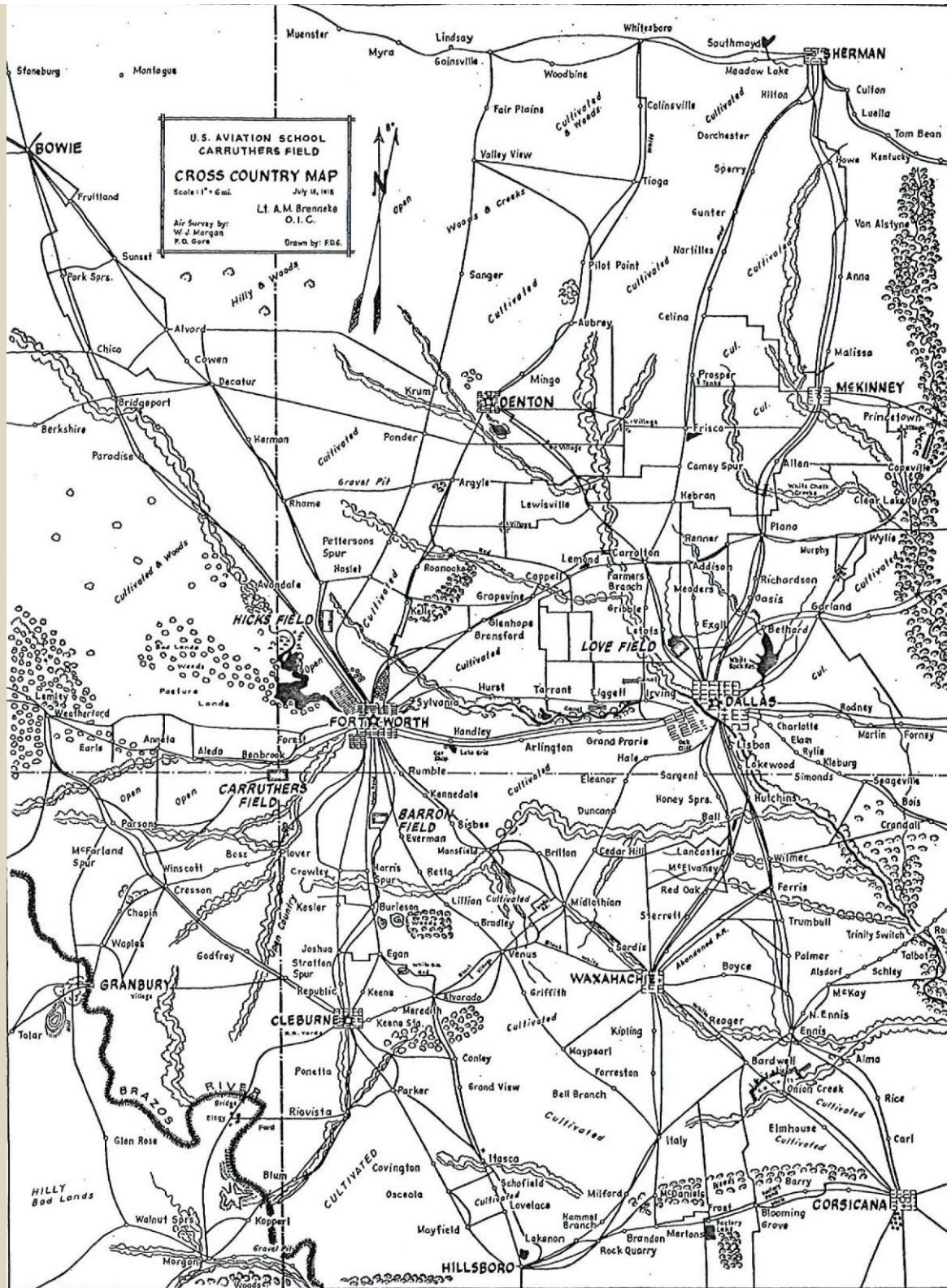



Concrete Airplane
Aerial View, note
fence



Concrete Airplane at
Taliaferro Field

8/03

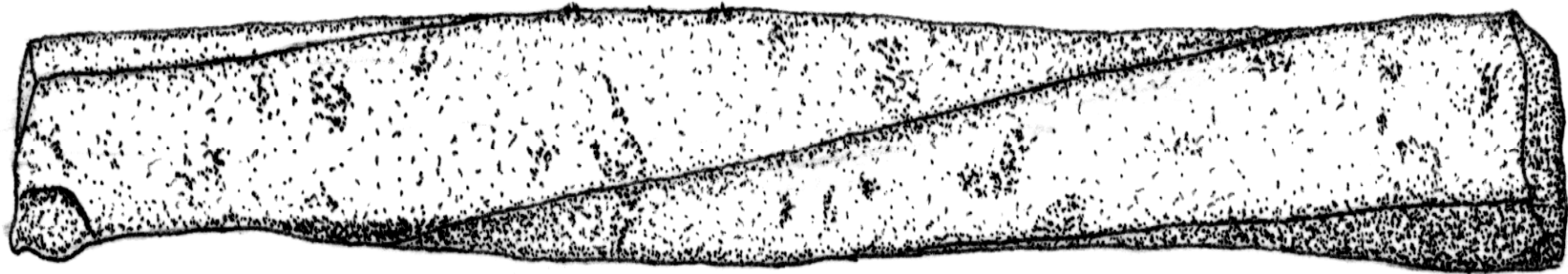

- Damascus twist rebar



Concrete Airplane
Tail Section

- All are more than 50 years old
 - All were unexpected
- Most were on private property
- Almost all were investigated in conjunction with federal or state environmental legislation
- Other Unique Historic Resources are out there to be found

An
AR CONSULTANTS
PRESENTATION

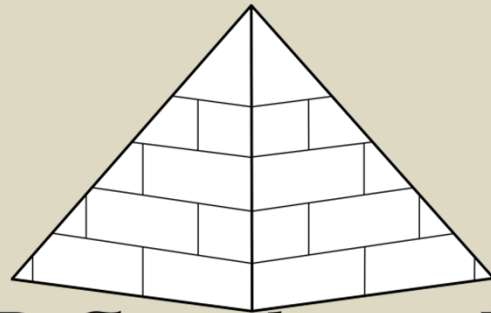

AR Consultants, Inc.

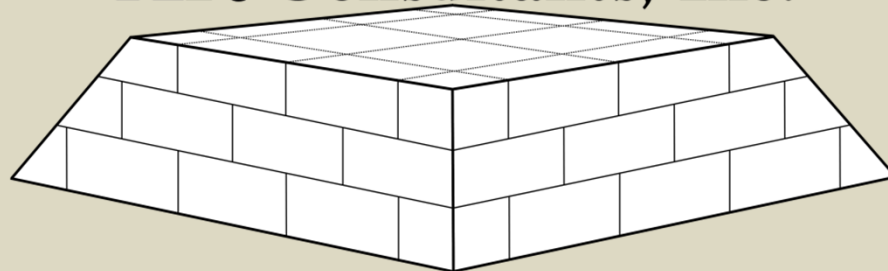

Archaeology and Environment

North tx map

- West Fork Bridge Pre
- Aubrey Clovis Pre
- LRR cabin and HABS
- Old Stone Dam 1873-present
- Redwine 1870-1960s
- Greenwood Cemetery
- Scott Cemetery 1880s-1930
- Chapel Hill WWI Target 1917-present





8/15/2012 8:32